

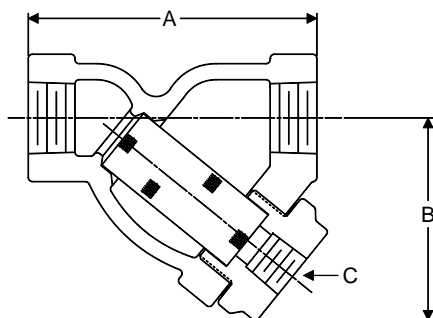

Cast Iron 250 lb Screwed 1/2" - 3"

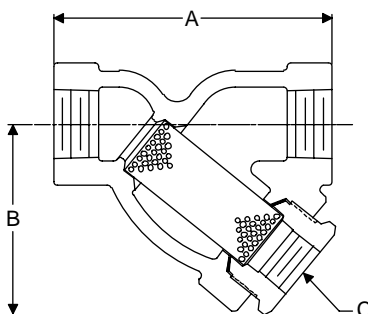

CA1SC/CA41SC 1/2", 3/4", 1", 1-1/2", 2"



CA1SC/CA41SC 1-1/4"

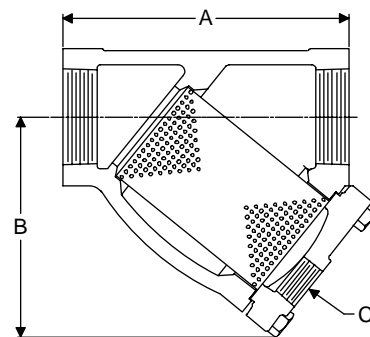

A1SC 2-1/2", 3"

For a fully detailed certified drawing, refer to:
CA1SC/CA41SC 1/2", 3/4", 1", 1-1/4", 1-1/2", 2" CD #1111
A1SC 2-1/2", 3" CD #1043

Pressure/Temperature Rating

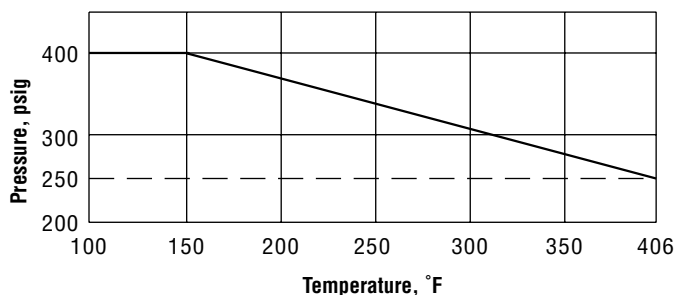

Materials: 250 lb Screwed 1/2" - 3" (15 - 80 mm)

Connections Size		Body	Standard Screen	Screen Retainer	Gasket	Bolting	
in	mm						
1/2, 3/4	15, 20	ASTM A48 Class 30 Cast Iron	30x30 SS Mesh or 304 SS .045" perforated†	ASTM A48 Class 30 Cast Iron	Spiral Wound	N/A	
1, 1-1/2, 2	25, 40, 50				Soft Steel		
1-1/4	32		304 SS .045" perforated†		Non-asbestos	Cap Screws ASTM A193 Gr. B7	
2-1/2, 3	65, 80						

†NOTE: Other screen materials available. See page S-6.

Physical Data: 250 lb Screwed 1/2" - 3" (15 - 80 mm)

Size		Ordering Code, Standard Screen	Weight		Dimensions						Maximum Pressure				Screen Retainer Type	Connections
					A		B		C		Saturated Steam		150°F (66°C) non-shock			
in	mm		lb	kg	in	mm	in	mm	in	mm	psig	bar	psig	bar		
1/2	15	CA1SC CA41SC	3	1.4	4-1/4	108	3	76	3/8	9.5	250	17	400	28	Threaded	ANSI B1.20.1 Screwed
3/4	20															
1	25		4-1/2	2	5	127	3-3/4	95	1/2	15						
1-1/4	32		7	3	5-1/2	140	3-7/8	98								
1-1/2	40		10	4.5	6-5/16	160	4-7/16	113								
2	50		15	6.8	7-1/2	191	5-7/16	138								
2-1/2	65	A1SC	24-1/2	11	8-1/2	216	6-7/16	164	3/4	20					Bolted	
3	80		45-1/2	21	10-1/2	267	8	203	1-1/4	32						

All dimensions and weights are approximate. Use certified print for exact dimensions. Design and materials are subject to change without notice.